

REVISIONS					
P	LTR	DESCRIPTION	DATE	DWN	APVD
	A	ECO-15-007308	14MAY2015	LL	SH

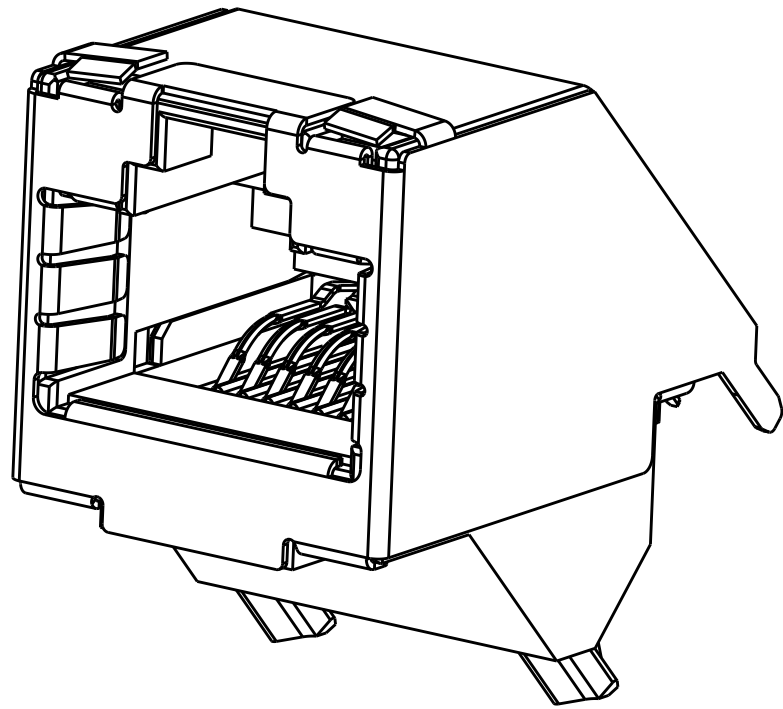

- ⚠ MATERIAL: HOUSING - HIGH TEMPERATURE THERMOPLASTIC, BLACK, UL 94V-0, IR REFLOW SOLDERING PROCESS COMPATIBLE.
TERMINALS - 0.18MM THICK PHOSPHOR BRONZE PLATED WITH 3.81µm MINIMUM THICK MATTE TIN IN SOLDER AREA, 0.76µm MINIMUM GOLD IN LOCALIZED PLATE AREA.
ENTIRE TERMINAL PLATED WITH 1.27µm[.000050] MINIMUM THICK NICKEL.
SHIELD - 0.25MM MIN THICK COPPER ALLOY, PREPLATED WITH 1.27µm THICK NICKEL AND 2.03µm MINIMUM HOT TIN DIP ON PCB GROUND TABS.
COMPENSATION PCB - FR-4.
- 2 JACK CAVITY CONFORMS TO FCC RULES AND REGULATIONS PART 68, SUBPART F.
- 3 PART NUMBER, DATE CODE TO BE MARKED IN APPROXIMATE LOCATION SHOWN.
4. FOR CAT6 APPLICATION, THE PART ITSELF CAN NOT MEET CAT6 PERFORMANCE, NECESSARY COMPENSATION ON CUSTOMER PCB IS MANDATORY.
- 5 WITHOUT THE CAP.

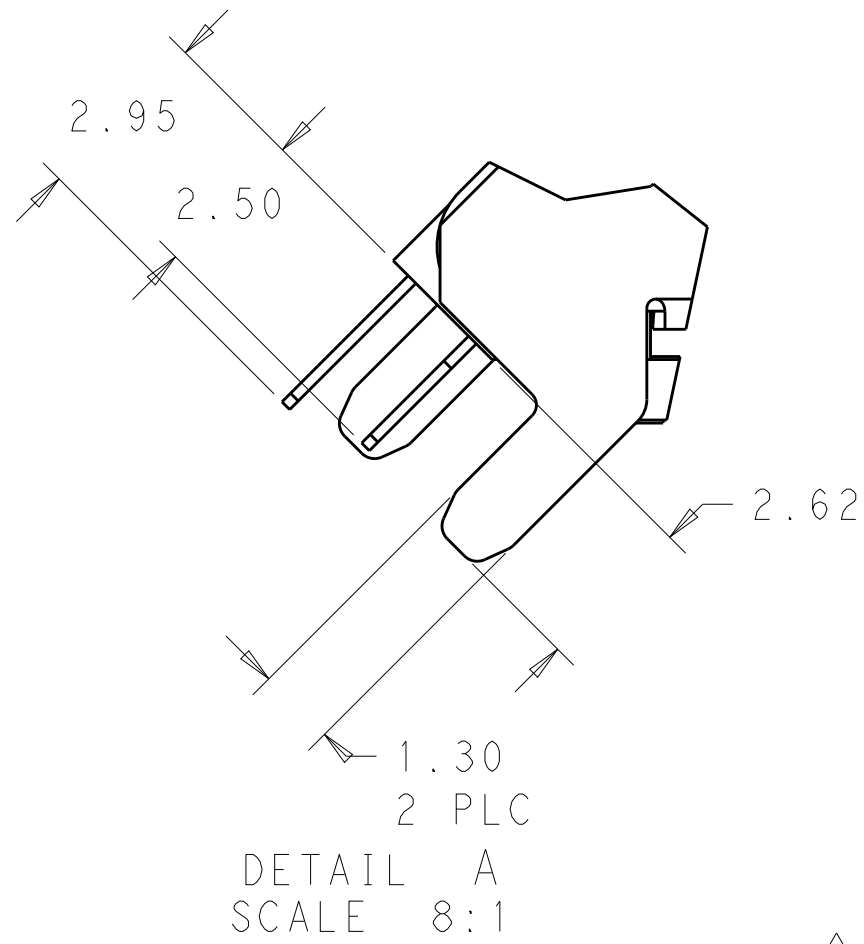
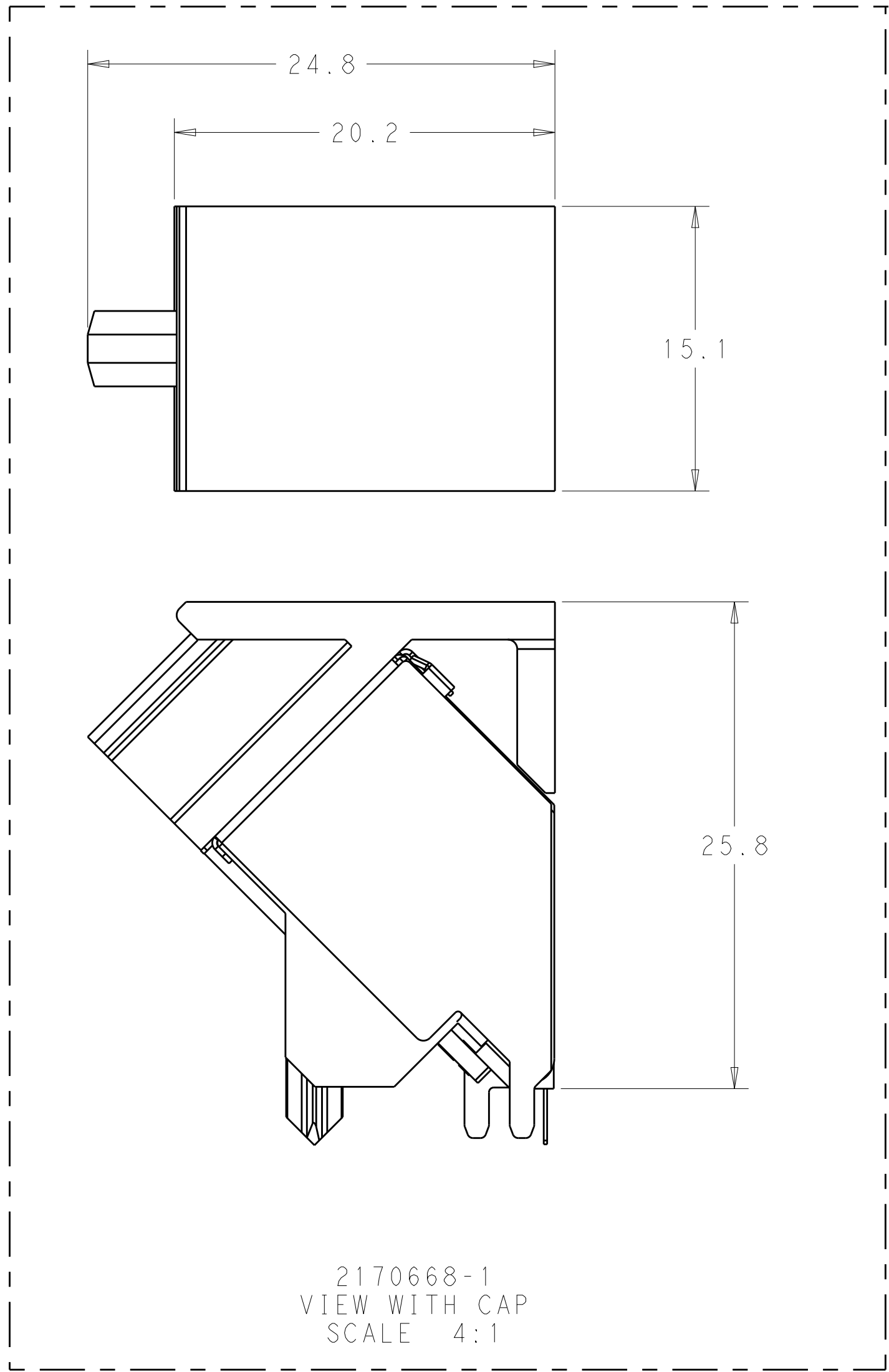
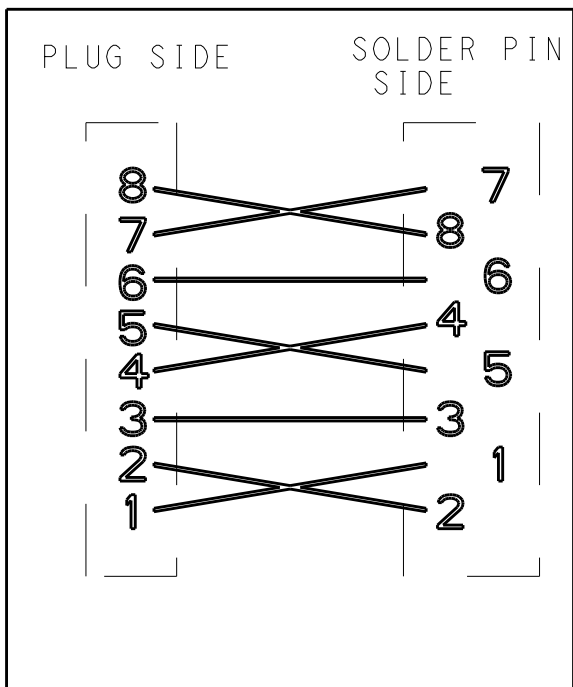
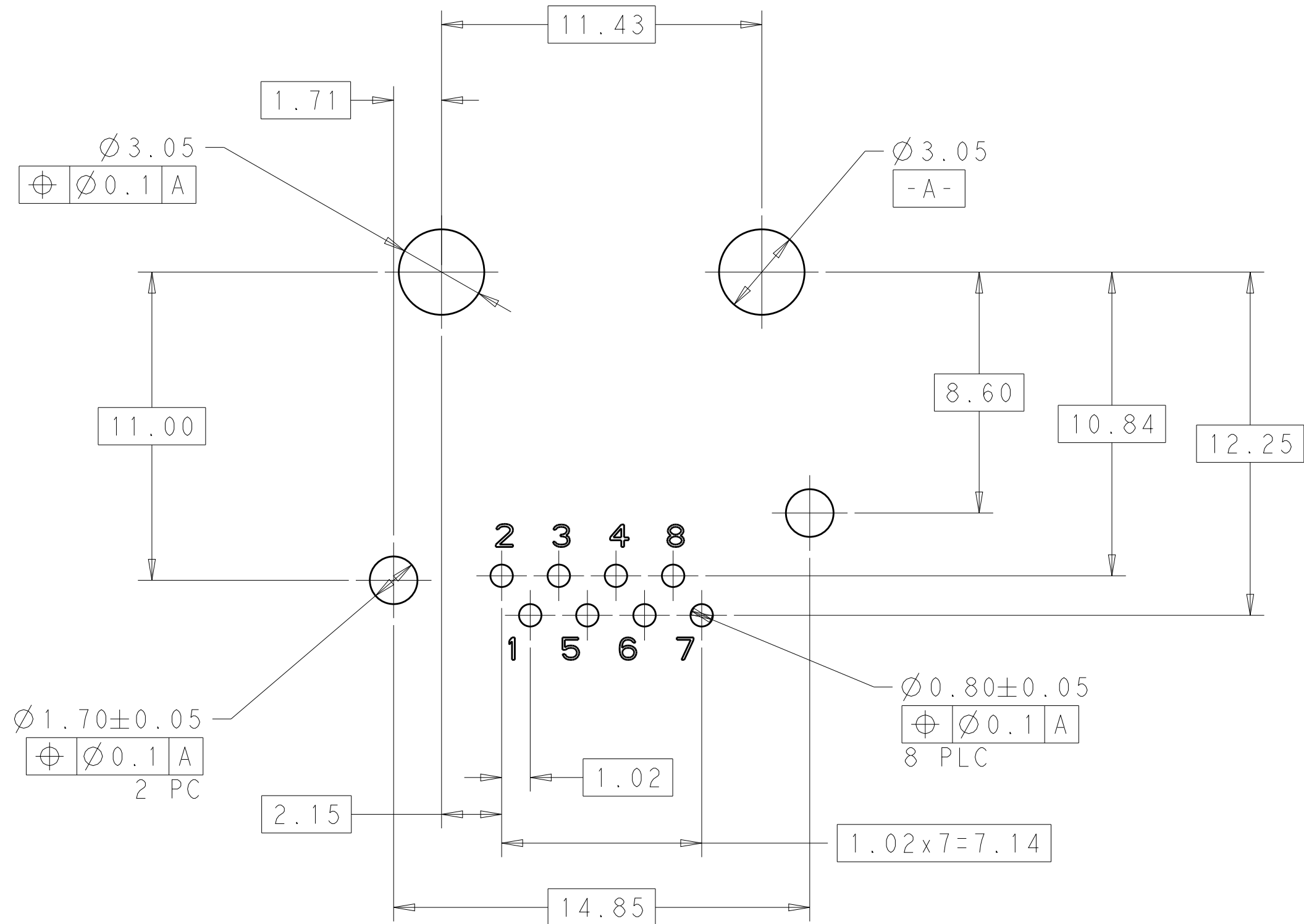
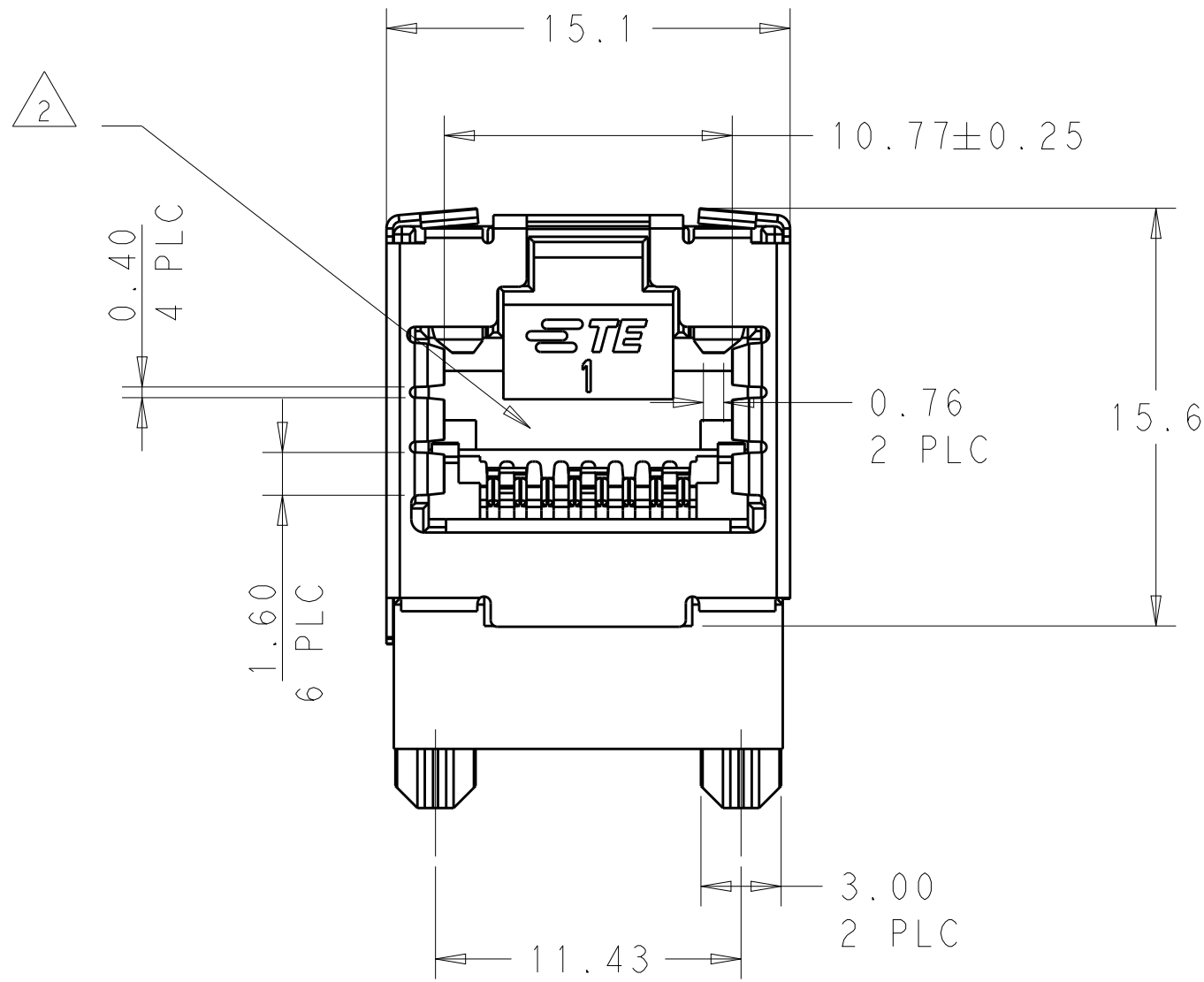
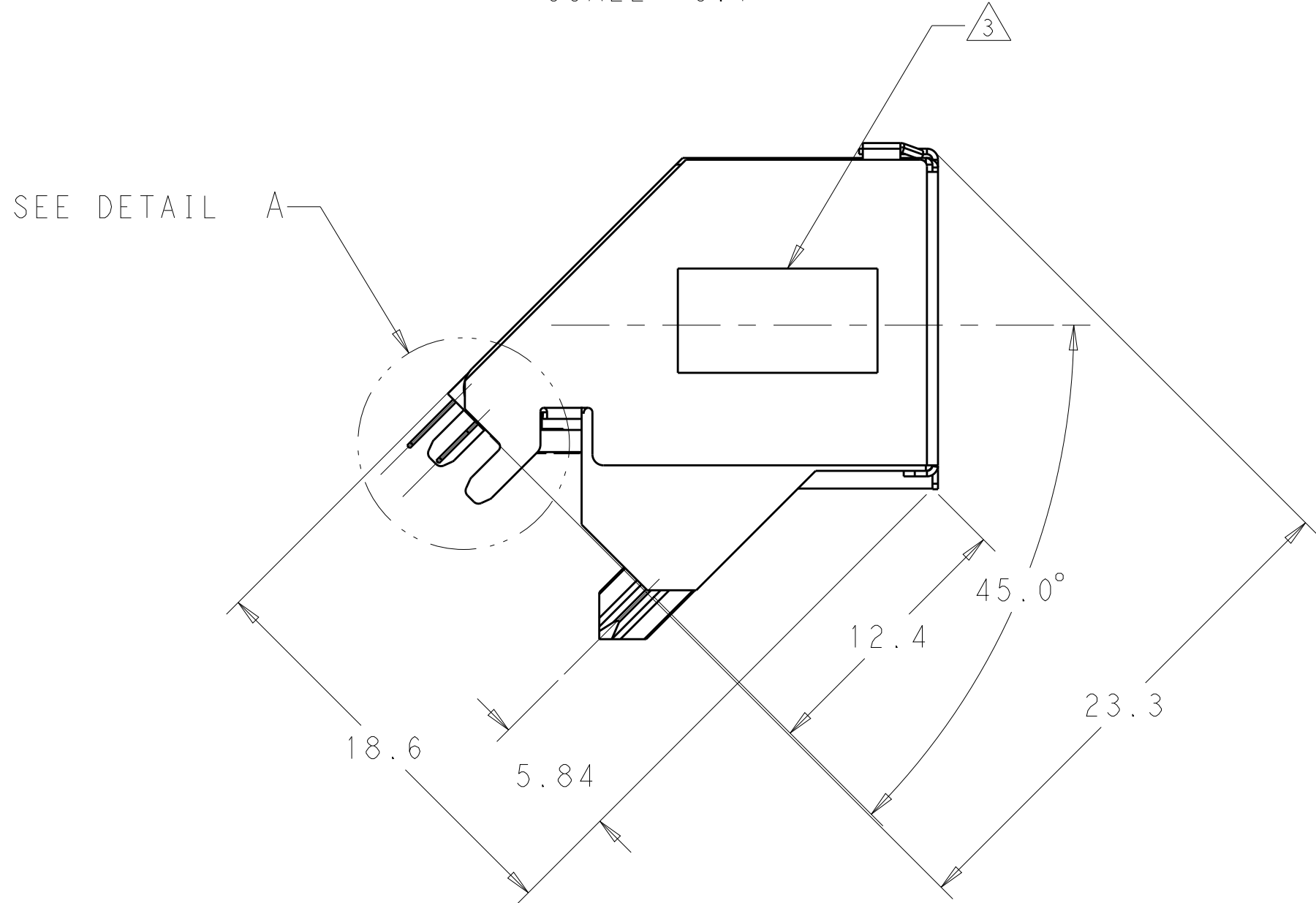

⚠	ESD TRAY	2170668-2
⚠	ESD TRAY	2170668-1
MATERIAL	PACKAGE	PART NUMBER

THIS DRAWING IS A CONTROLLED DOCUMENT.		DWN: LEO LI 25MAY2014	TE Connectivity	
DIMENSIONS: mm		CHK: SEAN HAN 25MAY2014		
		APVD: SEAN HAN 25MAY2014	NAME: ANGLED ENTRY JACK, SHIELDED RJ45, FOR CAT6 APPLICATION	
		PRODUCT SPEC		
TOLERANCES UNLESS OTHERWISE SPECIFIED:		APPLICATION SPEC	SIZE: A1	
0 PLC ±.25		WEIGHT		
1 PLC ±0.25		Customer Drawing	SCALE: 2:1	
2 PLC ±0.13				
3 PLC ±			SHEET 1 OF 1	
4 PLC ±				
ANGLES FINISH			REV A	
MATERIAL				